

#8M0092064

Instructions:

The Quick Release Bracket consists of a top and bottom plate. Separate top and bottom plate to mount. Determine location for mounting.

Top Plate:

Use the four 30 mm (B) bolts and attach the top plate onto the bottom of trolling motor. Use one small washer and a nylock nut per bolt then tighten firmly. The 22 mm (C) bolts are used in a specific location and insert from the top, see diagram below. Secure with small washer and nylock nut.

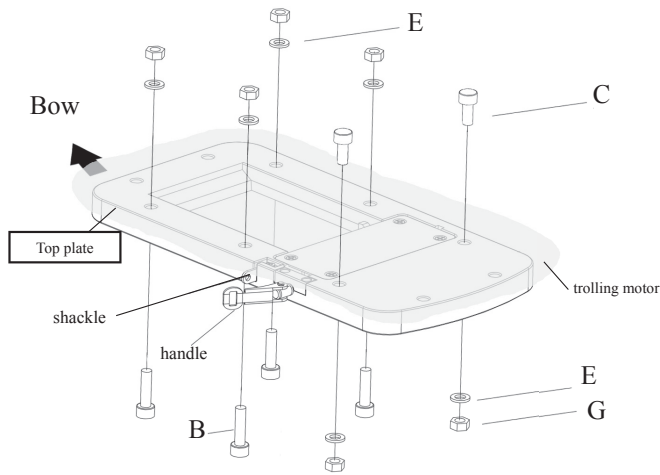

Kit Contents

- 1 - Top plate
- 1 - Bottom plate
- 1 - Hardware package
 - 6 M6 x 70 mm socket cap bolt (A)
 - 4 M6 x 30 mm socket cap bolt (B)
 - 2 M6 x 22 mm socket cap bolt (C)
 - 6 6.4 mm stainless steel washers-large (D)
 - 12 6.4 mm stainless steel washers-small (E)
 - 12 6.4 mm nylon washer (F)
 - 12 6.4 mm nylock nuts (G)

Required Tools for Installation:

- 6 mm (1/4 in) wrench
- drill
- 6 mm (1/4 inch) bit
- 10 mm socket and ratchet
- 10 mm wrench

Bottom Plate:

Using the bottom plate as a template, mark and pre-drill 6 mm holes in desired location. Using the 70 mm bolts, attach bottom plate to the boat. Insert bolts with a small washer from the top. Add 1 or 2 nylon washers above the boat deck and a large steel washer under the boat deck followed by the nylock nut. Tighten firmly.

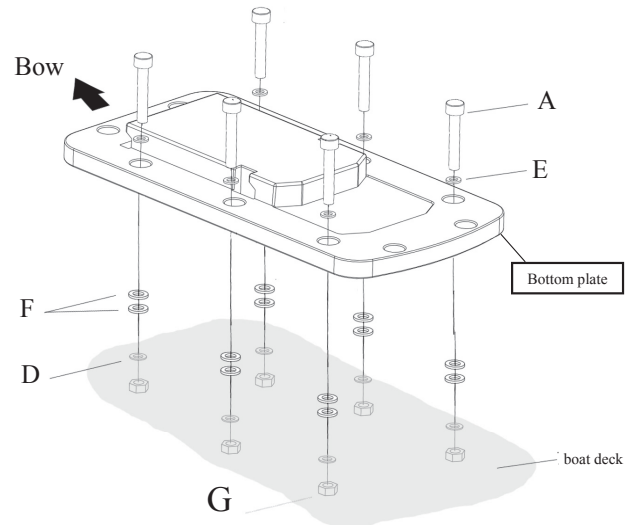

Attachment:

On the top plate, rotate the handle counter clockwise until it stops. Set top bracket over bottom bracket. Slide top bracket away from bow until it stops (about 1/4 inch). Turn handle clockwise until tight.

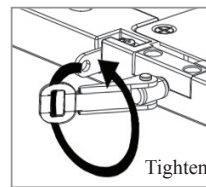
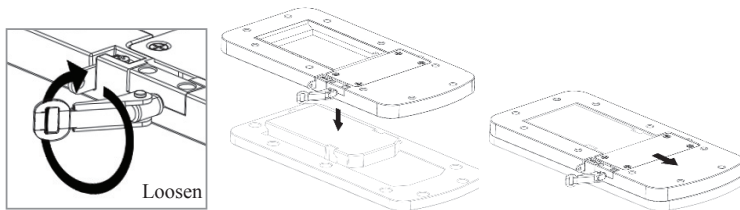

For security, seat handle over shackle and insert padlock (not included) to prevent removal of top bracket.

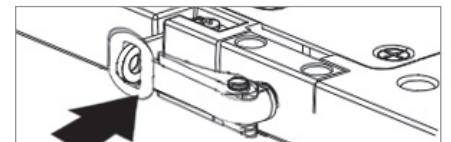

Detachment:

Rotate handle counterclockwise until it stops. Slide top bracket towards bow (about 1/4 inch). Lift and remove motor from boat.

